



12/14/2018

DocuSigned by: Thomas G. Santos
 SIGNATURE DATE SIGNATURE DATE
 5B0AUECC194B4EE...

NOTES:

FOR ROCK PLATING, SEE SECTION 275 OF THE STANDARD SPECIFICATIONS.

HOLD A PRECONSTRUCTION MEETING BEFORE CONSTRUCTION STARTS.

REMOVE FAILED SOIL MASS AT THE DIRECTION OF THE ENGINEER. TREAT THIS MATERIAL AS WASTE MATERIAL, PER SECTION 802 OF THE STANDARD SPECIFICATIONS.

SHAPE SLOPE FOR ROCK PLATING.

PLACE GEOTEXTILE UNDER RIP RAP.

COVER GEOTEXTILE WITH A MINIMUM OF 2 FEET OF RIP RAP AS SHOWN AND CONSTRUCT A 2:1 (H:V) SLOPE.

USE CLASS 1, 2, OR B RIP RAP UNLESS OTHERWISE DIRECTED BY THE ENGINEER.

ORIGINAL METRIC PROJECT PLANS WERE USED AS BASIS FOR PLAN VIEW SHOWN ON THIS SHEET. STATIONS SHOWN DEPICTING FAILURE AREA ON PLAN VIEW ARE IN METRIC UNITS.

REPAIR WORK WILL BE QUANTIFIED AND PAID IN ENGLISH UNITS ACCORDING TO THE 2018 STANDARD SPECIFICATIONS.

APPROXIMATE LENGTH AND WIDTH OF SLOPE FAILURE (AS MEASURED ON SLOPE FACE) IS 240 FEET AND 140 FEET, RESPECTIVELY.

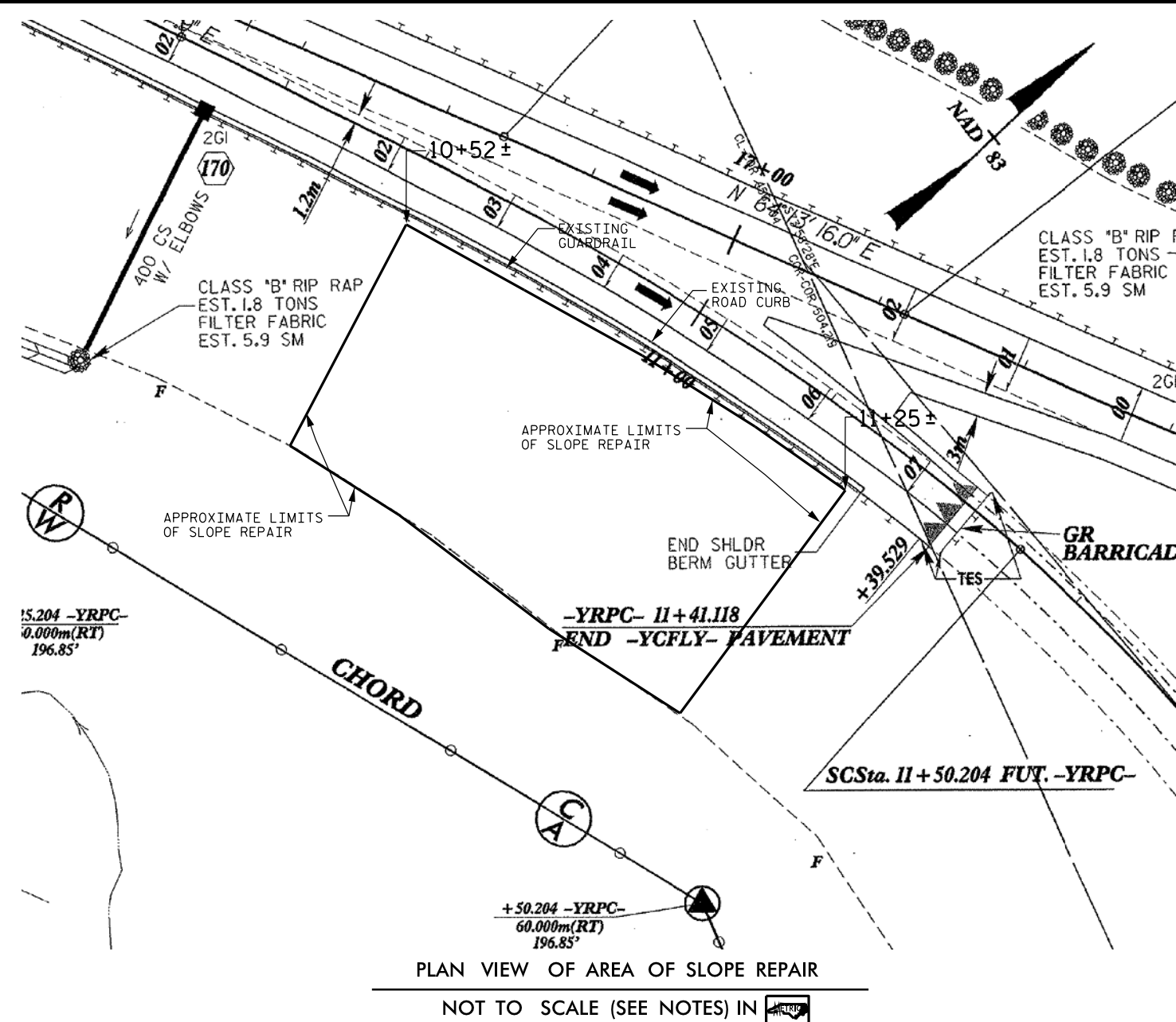

ESTIMATED QUANTITIES	
UNCLASSIFIED EXCAVATION	2500 CY
ROCK PLATING	4500 TONS

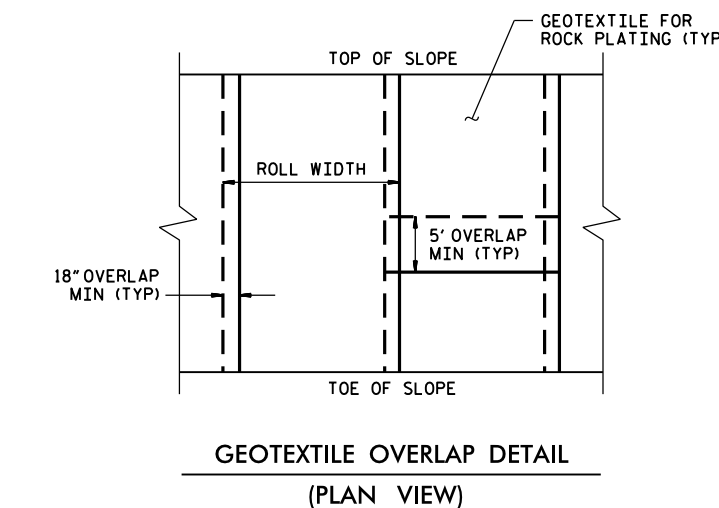
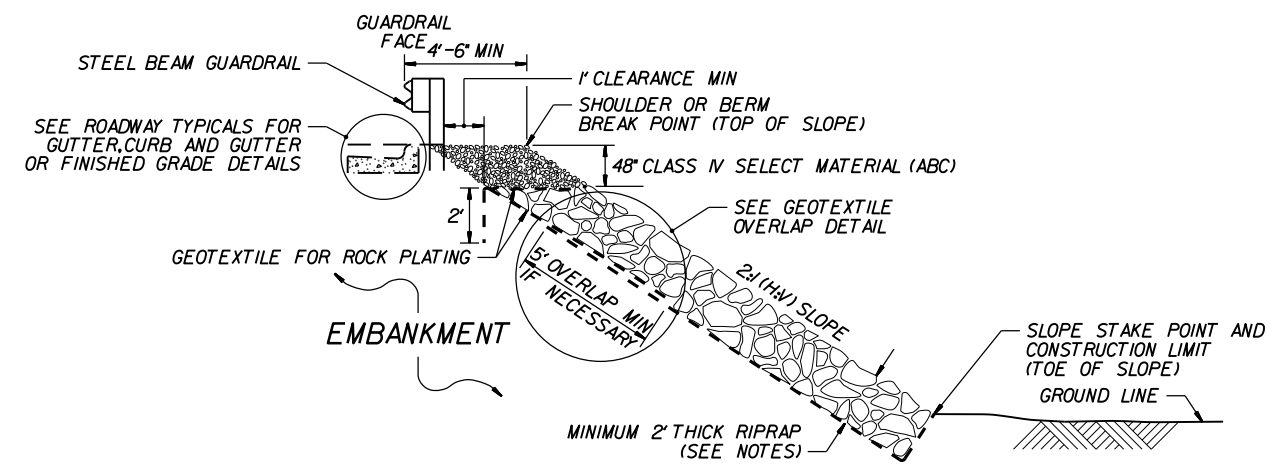

**NORTH CAROLINA
 DEPARTMENT OF TRANSPORTATION
 DIVISION OF HIGHWAYS**

**GEOTECHNICAL
 ENGINEERING UNIT**

**NC 540 -YRPC- SLOPE REPAIR
 ROCK PLATING**

REVISIONS					
NO.	BY	DATE	NO.	BY	DATE
1	TGS	12/13/18	3		
2			4		

6/2/99

14-DEC-2018 08:11
 U:\Projects\2018\14-2018-0000\14-2018-0000-Plan Review and Production Reviews\14-2018-0000AB Slope Repair\Examples\3338b_r.dwg.txd.dgn

PAVEMENT SCHEDULE (FINAL PAVEMENT DESIGN)	
C1	PROP. APPROX. 3" ASPHALT CONCRETE SURFACE COURSE, TYPE S9.5C, AT AN AVERAGE RATE OF 168 LBS. PER SQ. YD. IN EACH OF TWO LAYERS.
D1	PROP. APPROX. 4" ASPHALT CONCRETE INTERMEDIATE COURSE, TYPE I19.0C, AT AN AVERAGE RATE OF 456 LBS. PER SQ. YD.
J1	PROP. 8" AGGREGATE BASE COURSE.
J2	PROP. 48" AGGREGATE BASE COURSE.
N	GEOTEXTILE FOR PAVEMENT STABILIZATION
R1	CONCRETE EXPRESSWAY GUTTER
T	CLASS IV SELECT MATERIAL (ABC). SEE ROCK PLATING DETAIL.

Note: Approximate quantities only. Unclassified Excavation, Fine Grading, and Removal of Existing Pavement will be paid for at the contract lump sum price for "Grading."

ESTIMATED REMOVAL OF EXISTING ASPHALT PAVEMENT (CONTINGENCY) = 270 SY

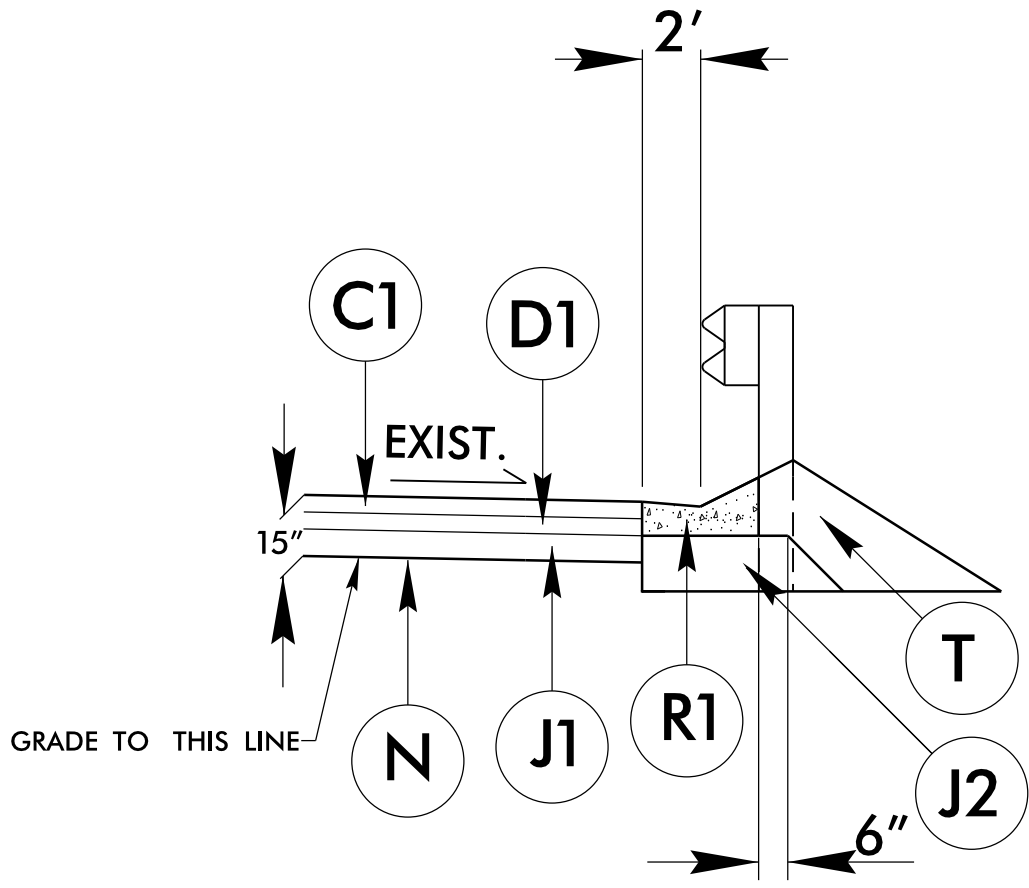

PROJECT REFERENCE NO. R-2000AB	SHEET NO. 2A-1
ROADWAY DESIGN ENGINEER <i>Roger C. Kullman</i>	PAVEMENT DESIGN ENGINEER
12/14/2018 DOCUMENT NOT CONSIDERED FINAL UNLESS ALL SIGNATURES COMPLETED	

INSET A

FOR USE IN AREAS OF PAVEMENT REMOVAL

EFF. 01-16-2018
 REV.

2018 ROADWAY ENGLISH STANDARD DRAWINGS

The following Roadway Standards as appear in "Roadway Standard Drawings" Highway Design Branch - N. C. Department of Transportation - Raleigh, N. C., Dated January, 2018 are applicable to this project and by reference hereby are considered a part of these plans:

STD.NO.	TITLE
DIVISION 3 - PIPE CULVERTS	
300.01	Method of Pipe Installation
DIVISION 8 - INCIDENTALS	
840.00	Concrete Base Pad for Drainage Structures
840.18	Concrete Grated Drop Inlet Type 'B' - 12" thru 36" Pipe
840.25	Anchorage for Frames - Brick or Concrete or Precast
840.27	Brick Grated Drop Inlet Type 'B' - 12" thru 36" Pipe
840.45	Precast Drainage Structure
840.66	Drainage Structure Steps
846.01	Concrete Curb, Gutter and Curb & Gutter
846.02	Drop Inlet Installation in Expressway Gutter
876.02	Guide for Rip Rap at Pipe Outlets

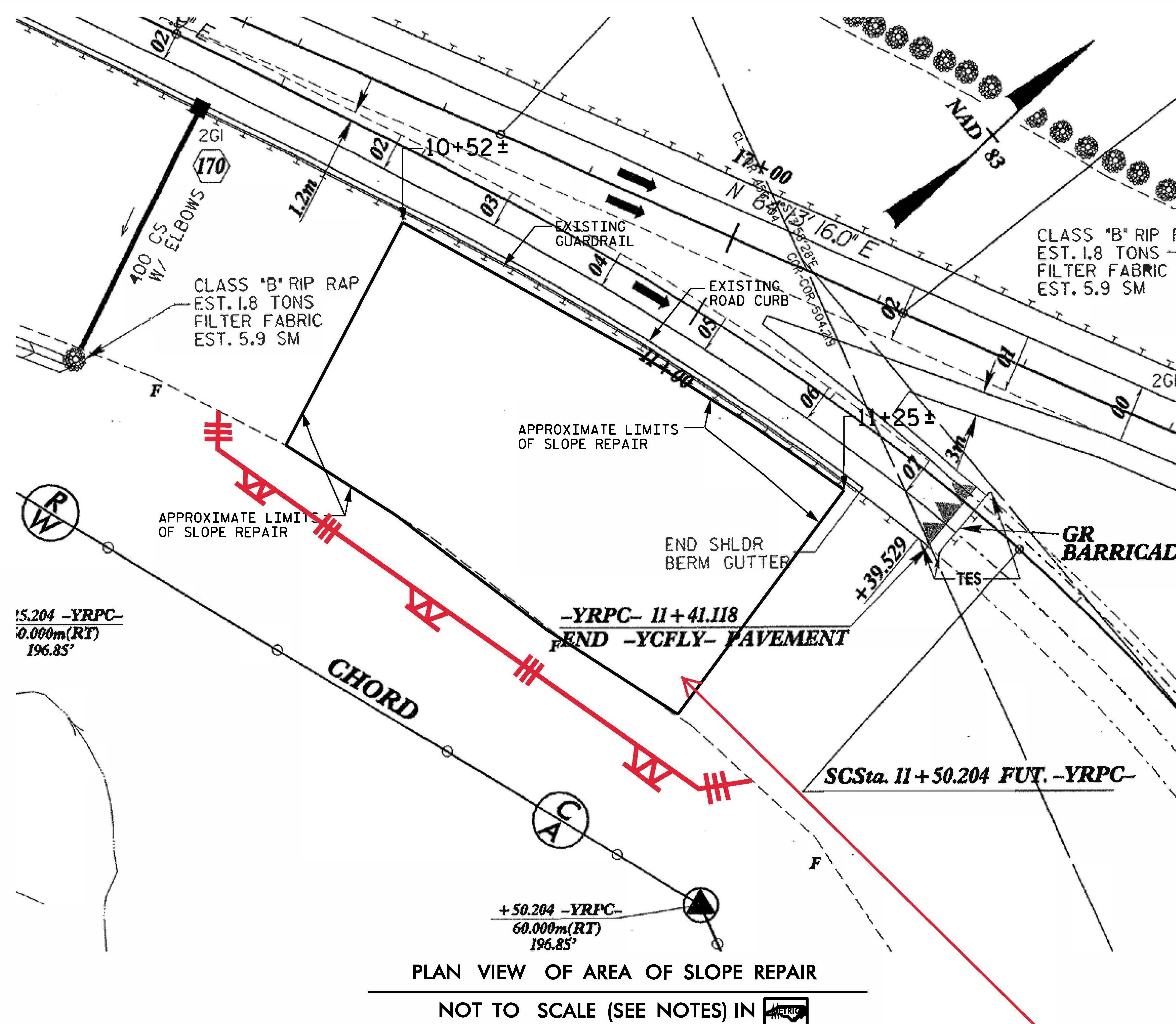

PLAN VIEW OF AREA OF SLOPE REPAIR
NOT TO SCALE (SEE NOTES) IN [Symbol]

EROSION AND SEDIMENT CONTROL MEASURES

Std. #	Description	Symbol
1630.03	Temporary Silt Ditch	[Symbol]
1630.05	Temporary Diversion	[Symbol]
1605.01	Temporary Silt Fence	[Symbol]
1606.01	Special Sediment Control Fence	[Symbol]
1622.01	Temporary Berms and Slope Drains	[Symbol]
1630.02	Silt Basin Type B	[Symbol]
1633.01	Temporary Rock Silt Check Type-A	[Symbol]
	Temporary Rock Silt Check Type-A with Matting and Polyacrylamide (PAM)	[Symbol]
1633.02	Temporary Rock Silt Check Type-B	[Symbol]
	Wattle/Coir Fiber Wattle	[Symbol]
	Wattle/Coir Fiber Wattle with Polyacrylamide (PAM)	[Symbol]
1634.01	Temporary Rock Sediment Dam Type-A	[Symbol]
1634.02	Temporary Rock Sediment Dam Type-B	[Symbol]
1635.01	Rock Pipe Inlet Sediment Trap Type-A	[Symbol]
1635.02	Rock Pipe Inlet Sediment Trap Type-B	[Symbol]
1630.04	Stilling Basin	[Symbol]
1630.06	Special Stilling Basin	[Symbol]
	Rock Inlet Sediment Trap:	
1632.01	Type A	[Symbol]
1632.02	Type B	[Symbol]
1632.03	Type C	[Symbol]
	Skimmer Basin	[Symbol]
	Tiered Skimmer Basin	[Symbol]
	Infiltration Basin	[Symbol]

Estimated EC Quantities

Geotextile for Drainage	75 SY
Temporary Silt Fence	400 LF
Erosion Control Stone, Class A	25 TON
Sediment Control Stone	15 TON
1/4" Hardware Cloth	50 LF
Matting for Erosion Control	1800 SY
Seeding and Mulching	0.5 ACR
Seed for Temporary Seeding	250 LB
Temporary Mulching	0.5 ACR
Fertilizer for Temporary Seeding	0.1 TON

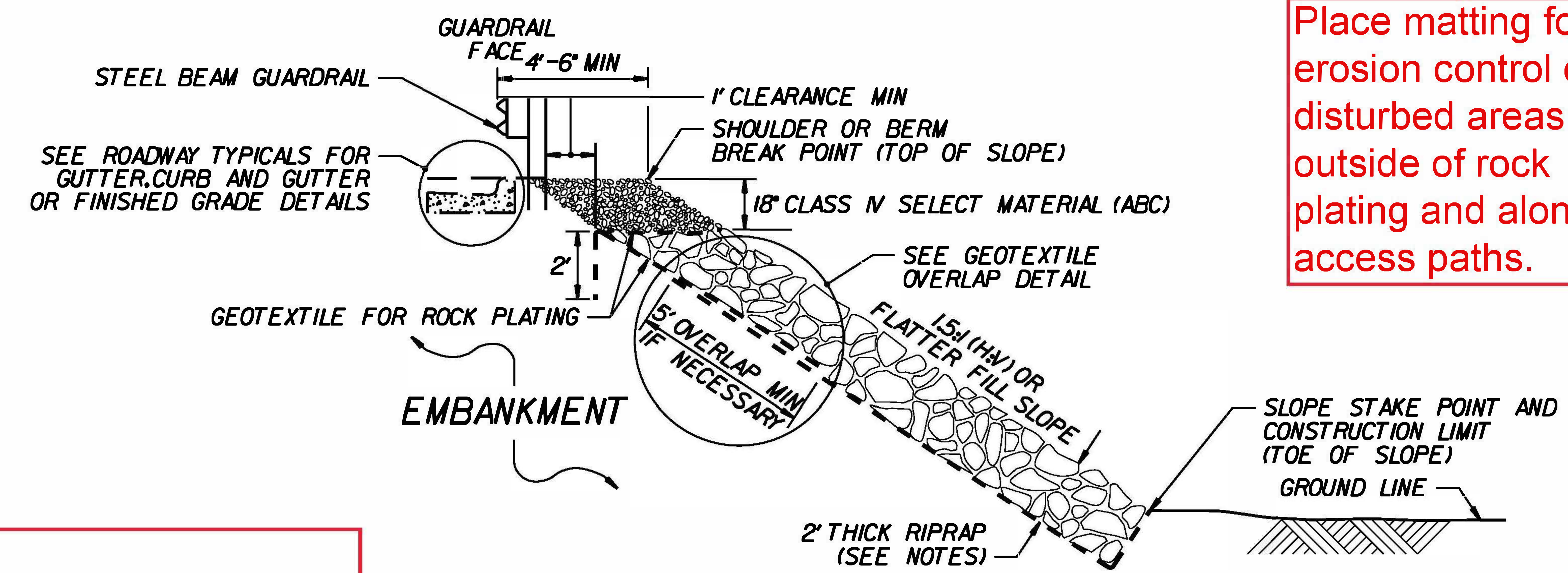

ROCK PLATING DETAIL - TYPICAL SECTION
NOT TO SCALE

Place matting for erosion control on disturbed areas outside of rock plating and along access paths.

Utilize Gravel Construction entrance for ingress/egress locations

These Erosion and Sediment Control plans comply with the regulations set forth by the NCG-10000 General Construction Permit effective August 1, 2016 and issued by the North Carolina Department of Environmental Quality Division of Water Resources.

SOIL STABILIZATION TIMEFRAMES

SITE DESCRIPTION	STABILIZATION TIME	TIMEFRAME EXCEPTIONS
PERIMETER DIKS, SWALES, DITCHES AND SLOPES	7 DAYS	NONE
HIGH QUALITY WATER (HOW) ZONES	7 DAYS	NONE
SLOPES STEEPER THAN 3H	7 DAYS	IF SLOPES ARE 10' OR LESS IN LENGTH AND ARE NOT STEEPER THAN 2H, 14 DAYS ARE ALLOWED.
SLOPES 3H OR FLATTER	14 DAYS	7 DAYS FOR SLOPES GREATER THAN 50' IN LENGTH.
ALL OTHER AREAS WITH SLOPES FLATTER THAN 4H	14 DAYS	NONE, EXCEPT FOR PERIMETERS AND HOW ZONES.

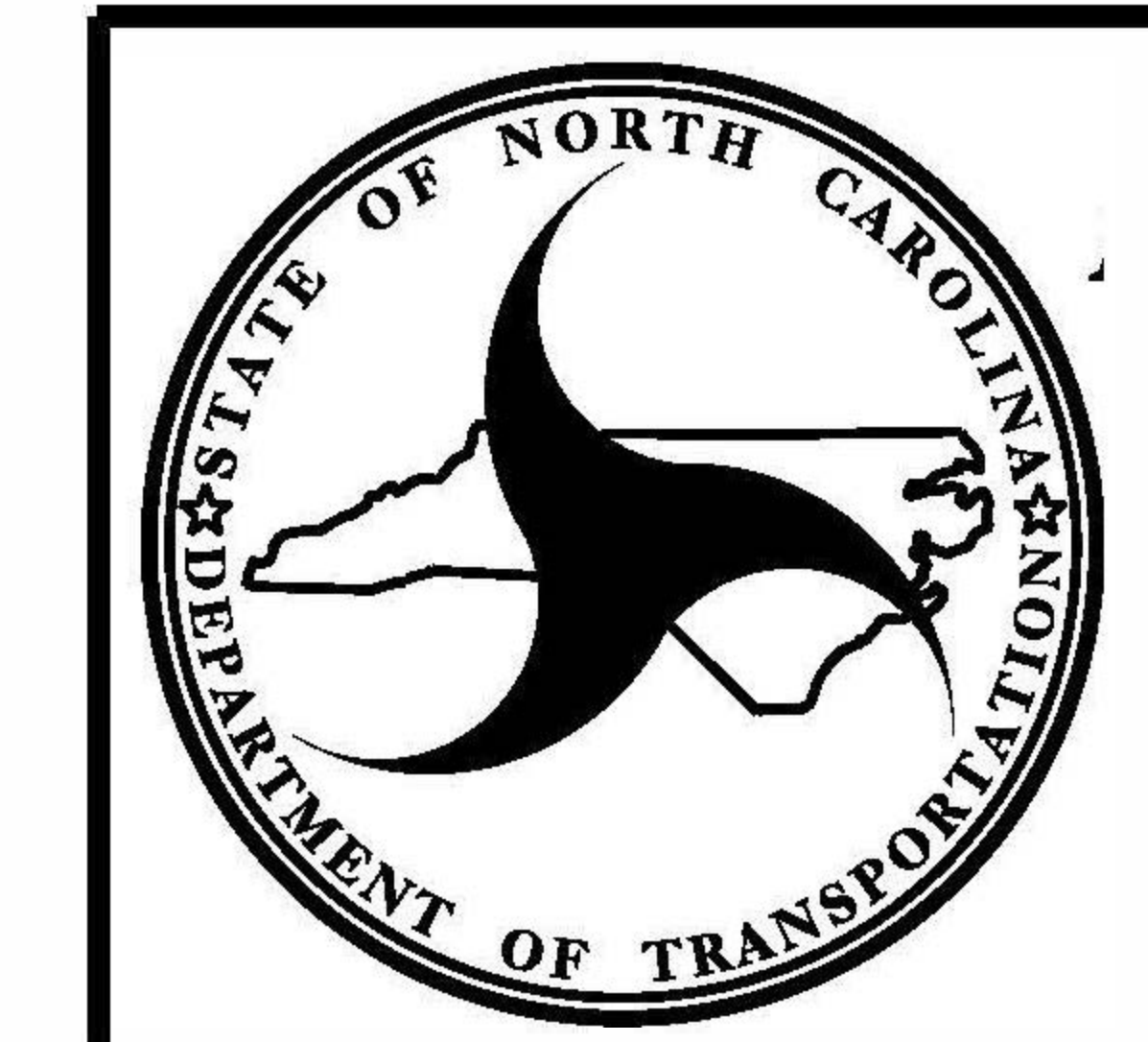

Prepared in the Office of:
ROADSIDE ENVIRONMENTAL UNIT
1 South Wilmington St.
Raleigh, NC 27611
2018 STANDARD SPECIFICATIONS
Designed by:
Noelle Ring 3456
NAME LEVEL III CERTIFICATION NO.

NC 540 -YRPC- SLOPE REPAIR ROCK PLATING

REVISIONS					
NO.	BY	DATE	NO.	BY	DATE
1			3		
2			4		

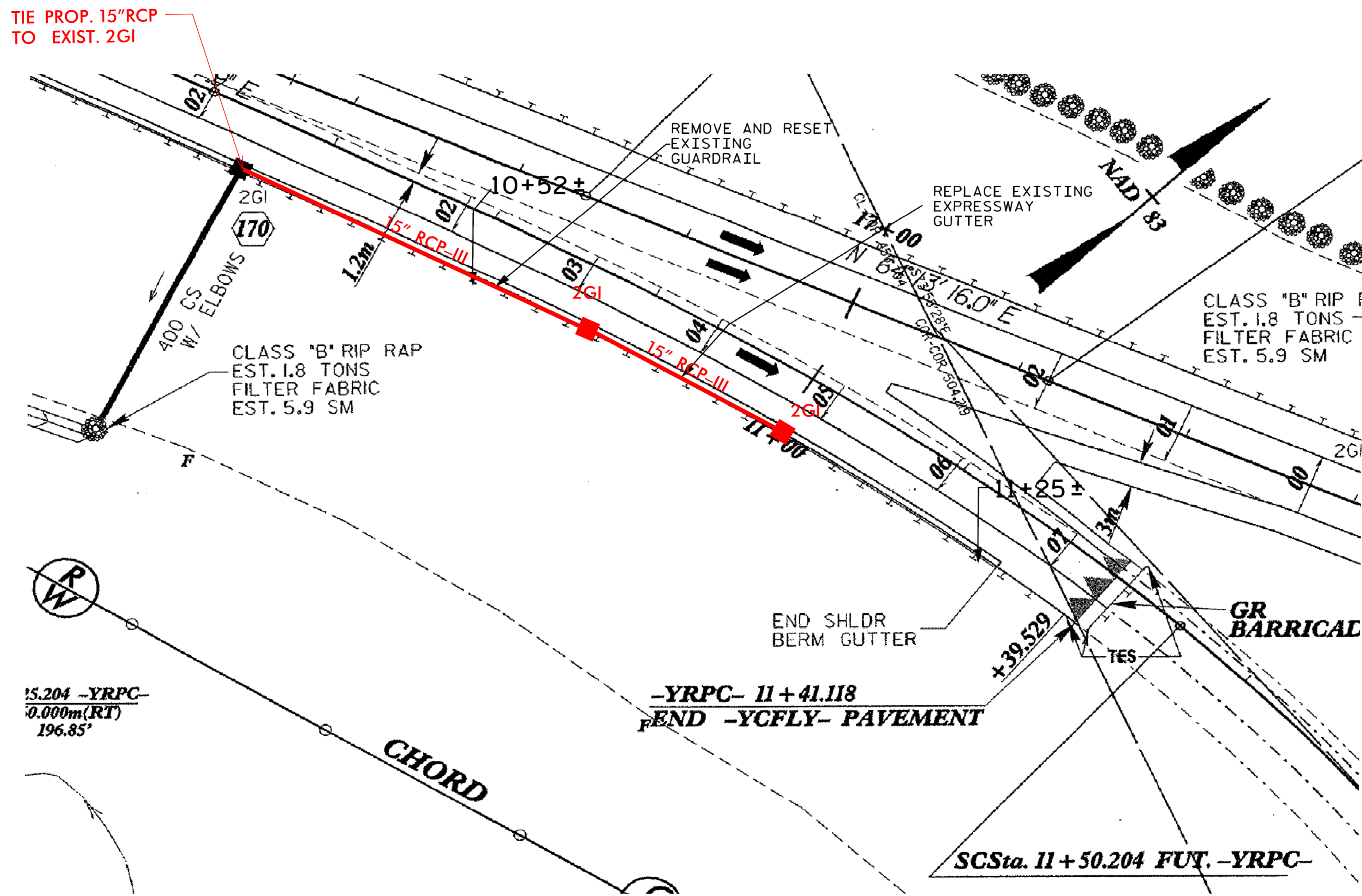
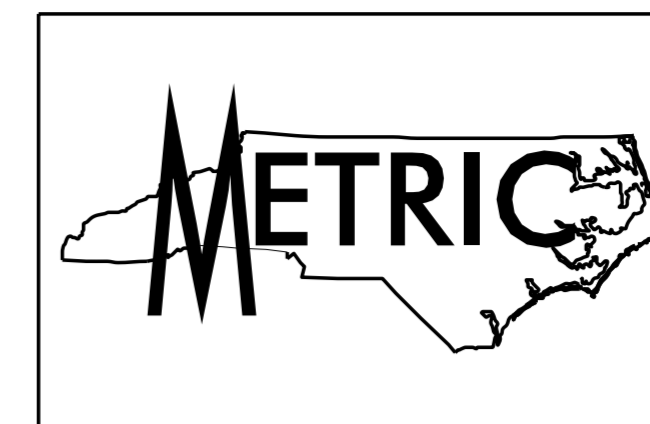

PLAN VIEW OF AREA OF SLOPE REPAIR

NOT TO SCALE

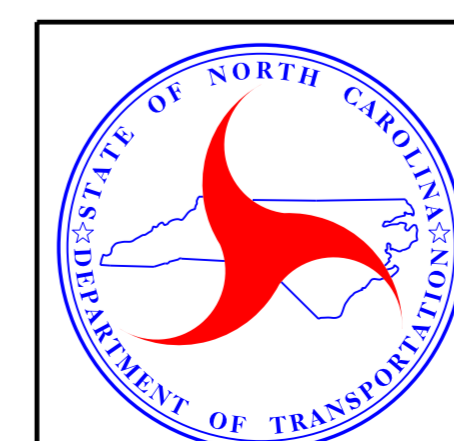

NORTH CAROLINA DEPARTMENT OF TRANSPORTATION DIVISION OF HIGHWAYS

NC 540 -YRPC- SLOPE REPAIR

PREPARED BY: R.C.K.	DATE: 12/2018
REVIEWED BY:	DATE:

REVISIONS					
NO.	BY	DATE	NO.	BY	DATE
1			3		
2			4		